

Owner
JULIANNE DESMOND
2042 PACIFIC AVE.
ALAMEDA, CA.
94501

Designer
JOSEPH A LANDRY
2834 ADAMS ST
ALAMEDA CA 94501
T: (510) 381-4159

Structural Engineer:

Proposed Contractor Builder:

2042 PACIFIC
AVENUE
94501

Rev. Date Remarks

Date: 07/30/18
Scale: AS NOTED
Project Name: 2042 PACIFIC AVE.
ALAMEDA, CA.
Project No. 106.18

Drawing Title:
ELECTRICAL
NEW STUDIO PLAN

Sheet No.
E-3.2

LEGEND

- (E) — EXISTING
- (N) — NEW
- ⊕ — ELECTRICAL OUTLET
- GFI ⊕ — ELECTRICAL OUTLET (GFI)
- SD — SMOKE DETECTOR
- ⊞ — VENT WITH HUMIDISTAT
- ⊙ — RECESSED DOWN LIGHTS
- \$ — WALL SWITCH
- ⊕ — LIGHT-LED
- CMA — CARBON MONOXIDE ALARM
- ∇ — WALL SCONCE
- UNDER CAB LIGHT

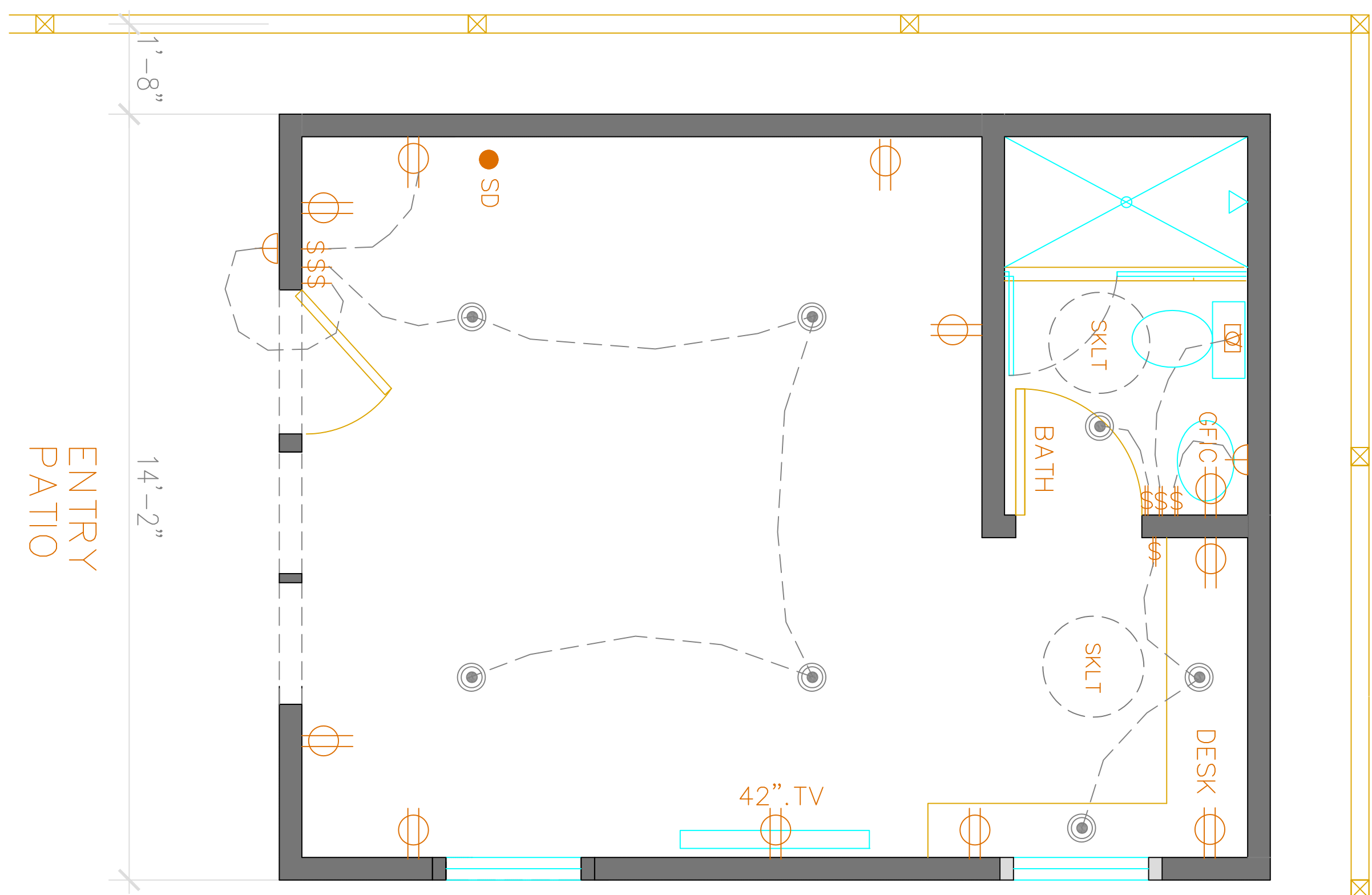

**ELECTRICAL
PLAN LAYOUT**

SCALE: 1/4" = 1'-0"

1
E-3.2