

JOSEPH LANDRY DESIGN

Owner
 JULIANNE DESMOND
 2042 PACIFIC AVE.
 ALAMEDA, CA.
 94501

Designer
 JOSEPH A LANDRY
 2834 ADAMS ST
 ALAMEDA CA 94501
 T: (510) 381-4139

Structural Engineer:

Proposed Contractor Builder:

2042 PACIFIC
 AVENUE
 94501

Rev. Date Remarks

Date: 07/30/18
 Scale: AS NOTED
 Project Name: 2042 PACIFIC AVE.
 ALAMEDA, CA.
 Project No. 10618

Drawing Title:
 ENLARGED
 NEW STUDIO PLAN

Sheet No.
 A-3.2

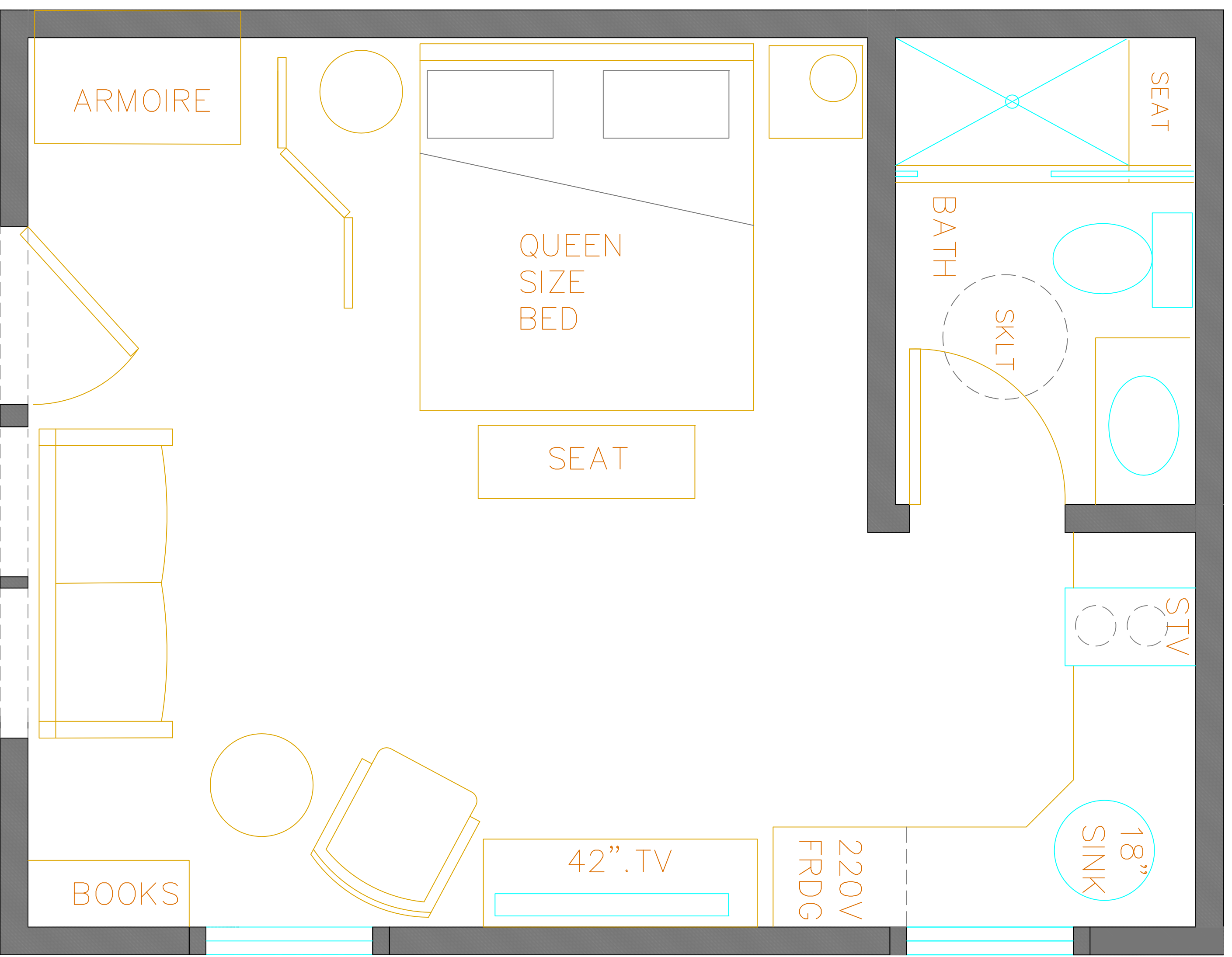

250 SF.
 STUDIO

PROPOSED ENLARGED
 PLAN LAYOUT

1
 A-3.2
 SCALE: 1/2" = 1'-0"